

USB 3.0 SP3022

2-Port USB 3.0 Multimode Fiber Extender System

Quick Start Guide

Before you get started, ensure that all the drivers required for your USB device(s) are installed noting this product does not support USB 1.1 or 2.0 devices.

1 In your computer settings, disable the **Suspend** feature.

a) For Windows, open the **Control Panel**, then select **Power Options**.

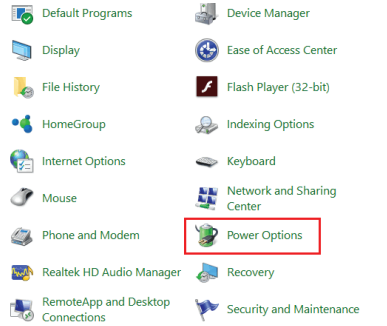

b) For each of the plans listed, click on **Change plan settings**.

Choose or customize a power plan

A power plan is a collection of hardware and system settings (like display brightness, sleep, etc.) that manages how your computer uses power. [Tell me more about power plans](#)

Preferred plans

- Balanced (recommended)**
Automatically balances performance with energy consumption on capable hardware. Change plan settings
- Power saver**
Saves energy by reducing your computer's performance where possible. Change plan settings

Show additional plans

c) Select **Never** for **Put the computer to sleep** for all the configurations presented. Then click **Change advanced power settings**.

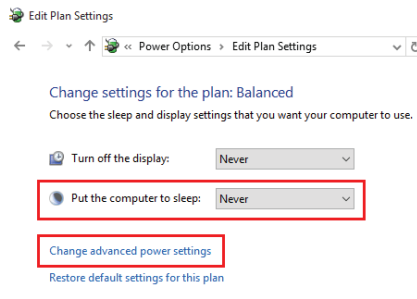

d) Expand **USB settings**. Expand **USB selective suspend setting**. Select **Disabled** for all options listed.

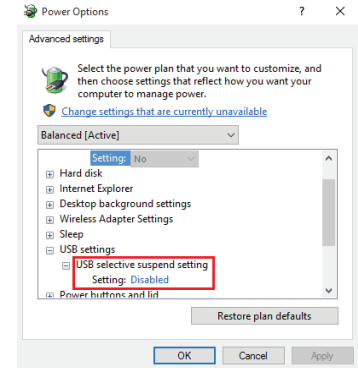

For more information and steps to disable your computer's suspend feature, refer to the SP3022 user guide.

Package Contents:

- USB 3.0 SP3022 Local Extender
- USB 3.0 SP3022 Remote Extender
- Locking AC Power Adapter
- Country Specific Power Cord
- USB 3.0 Cable
- Quick Start Guide

2 Place the Remote Extender unit where desired and attach the USB 3.0 device(s) to the Remote Extender.

Remote Extender (front view)



Note: AIA USB3 Vision™ locking USB connectors supported.

3 Power the Remote Extender with the included adapter and tighten the locking ring.

Remote Extender (rear view)



4 Remove the white sticker from the back of the Local Extender (if still affixed). Directly connect the Local and Remote Extenders with a Duplex LC crossover multimode fiber cable (not included).



Max. distance between Local and Remote Extenders: Up to 50m with USB 3.0 storage type devices and up to 100m when using USB 3.0 bulk traffic cameras.

5 Connect the Local Extender to a computer with the included USB cable.



Certification, Compliance and Warranty Information

FCC Radio Frequency Interference Statement Warning

This device complies with part 15 of the FCC Rules. Operation is subject to the following two conditions: (1) this device may not cause harmful interference, and (2) this device must accept any interference received including interference that may cause undesired operation.

CE Statement

We, Icron Technologies Corporation, a Maxim Integrated brand, declare under our sole responsibility that the USB 3.0 SP3022, to which this declaration relates, is in conformity with European Standards EN 55024, EN 55032, EN 61000, and RoHS Directive 2011/65/EU + 2015/863/EU.

IC Statement

This Class B digital apparatus complies with Canadian ICES-003.

WEEE Statement

The European Union has established regulations for the collection and recycling of all waste electrical and electronic equipment (WEEE). Implementation of WEEE regulations may vary slightly by individual EU member states. Please check with your local and state government guidelines for safe disposal and recycling or contact your national WEEE recycling agency for more information.

Product Operation and Storage

Please read and follow all instructions provided with this product and operate for intended use only. Do not attempt to open the product casing as this may cause damage and will void warranty. Use only the power supply provided with this product. When not in use, product should be stored in a dry location between -20°C and 70°C.

Icron Technologies Corporation
A Maxim Integrated Brand
4664 Lougheed Hwy., Suite 221
Burnaby, BC
V5C 5T5, Canada
+1 604 638 3920



Copyright © 2020 Icron | A Maxim Integrated Brand.
All rights reserved. Information contained herein is
subject to change without notice. ♻️



90-01060-B01